



## Richens Close , Hounslow, TW3 1PL

- 2 cosy bedrooms
- Spacious reception room
  - Built in 2002
  - Located in Hounslow
- Easy access to transport
- 1 modern bathroom
- Terraced house style
- 625 sq ft living space
- Close to local amenities
- Ideal for small families



Local Authority  
Council Tax Band **E**  
EPC Rating **C**



### Richen Close TW7

Approximate Gross Internal Floor Area = 59.2 sq m / 638 sq ft

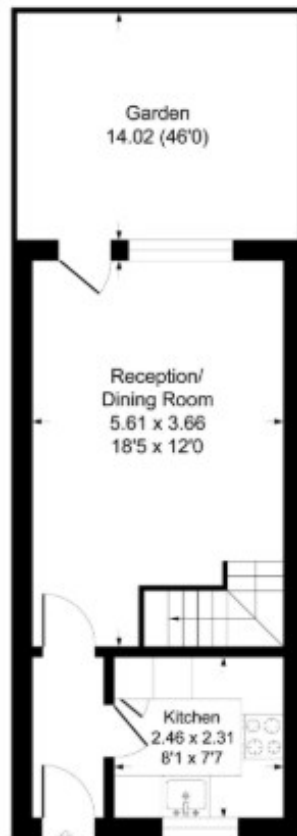

Ground Floor

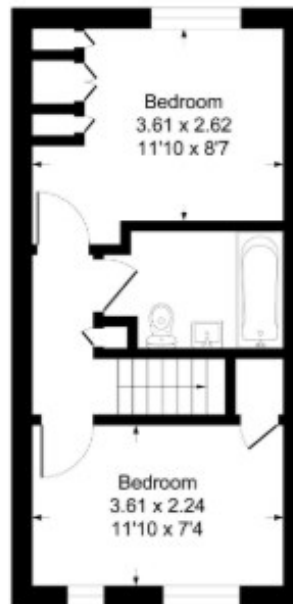

First Floor

#### Smartsale4u Office

Suite 331 Kemp House, 152-160 City Road, London, EC1V 2NX

#### Contact

0204 572 9091  
info@smartsale4u.co.uk  
smartsale4u.co.uk

Agents Note: Whilst every care has been taken to prepare these particulars, they are for guidance purposes only. All measurements are approximate and for general guidance purposes only and whilst every care has been taken to ensure accuracy, they should not be relied upon and potential buyers/tenants are advised to recheck the measurements.